

REVISIONS				
NO	DESCRIPTION	DATE	BY	APR/DATE
0	ISSUED FOR MANUFACTURE	05/12/10		
1	ADDED SECTIONS 2-C-8 & 2-D-8	2/21/11		

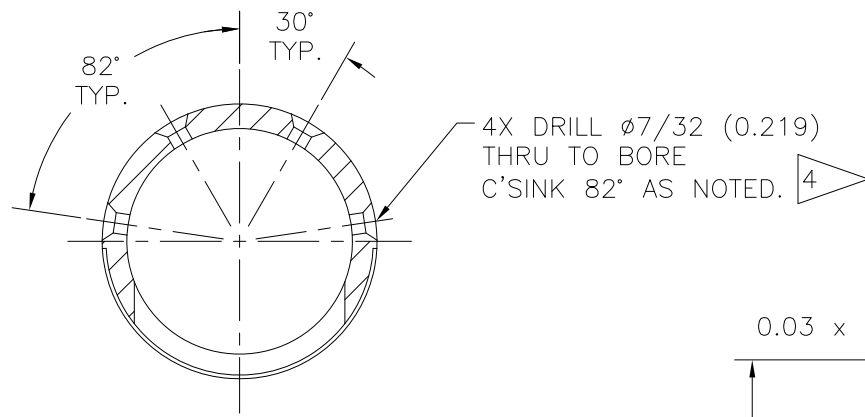

SECTION 2-D-8
SCALE: FULL

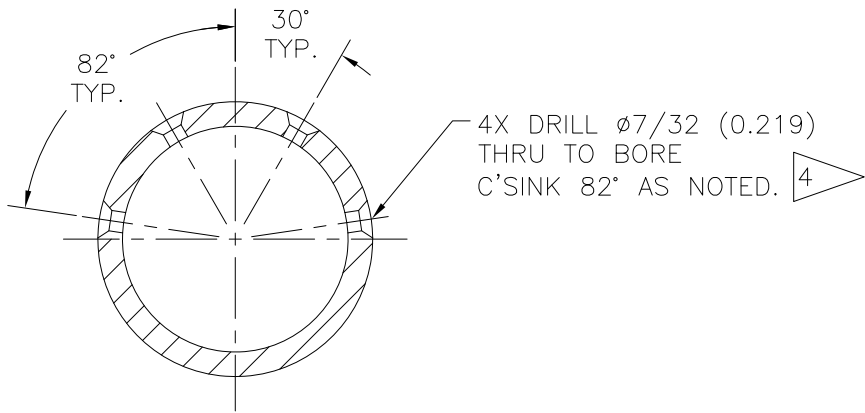

SECTION 2-C-8
SCALE: FULL

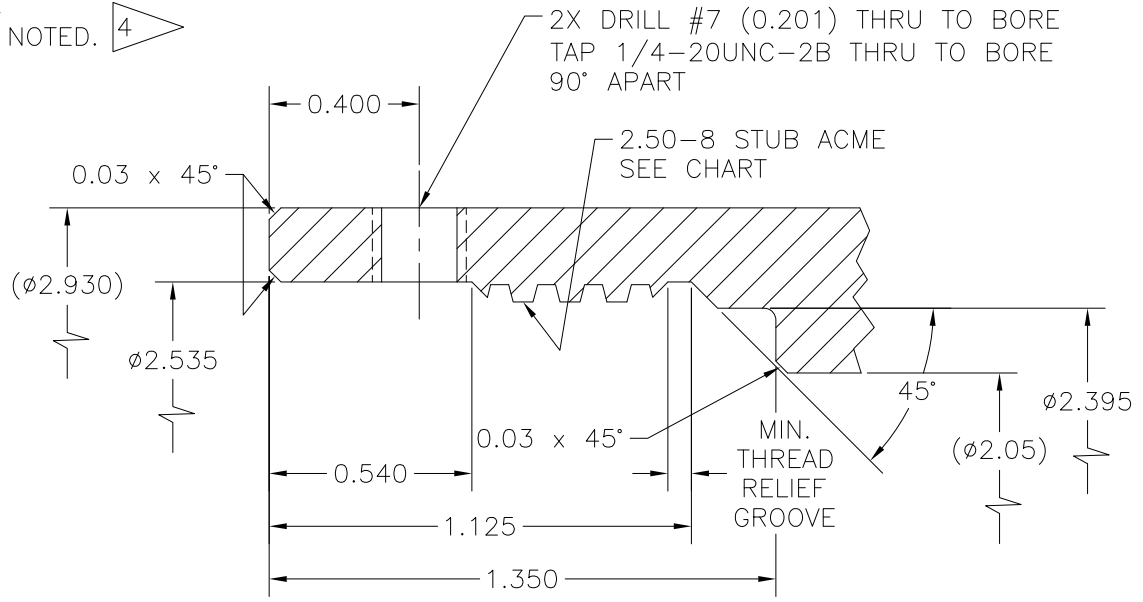

DETAIL 2-C-5
REF. 1-C-8

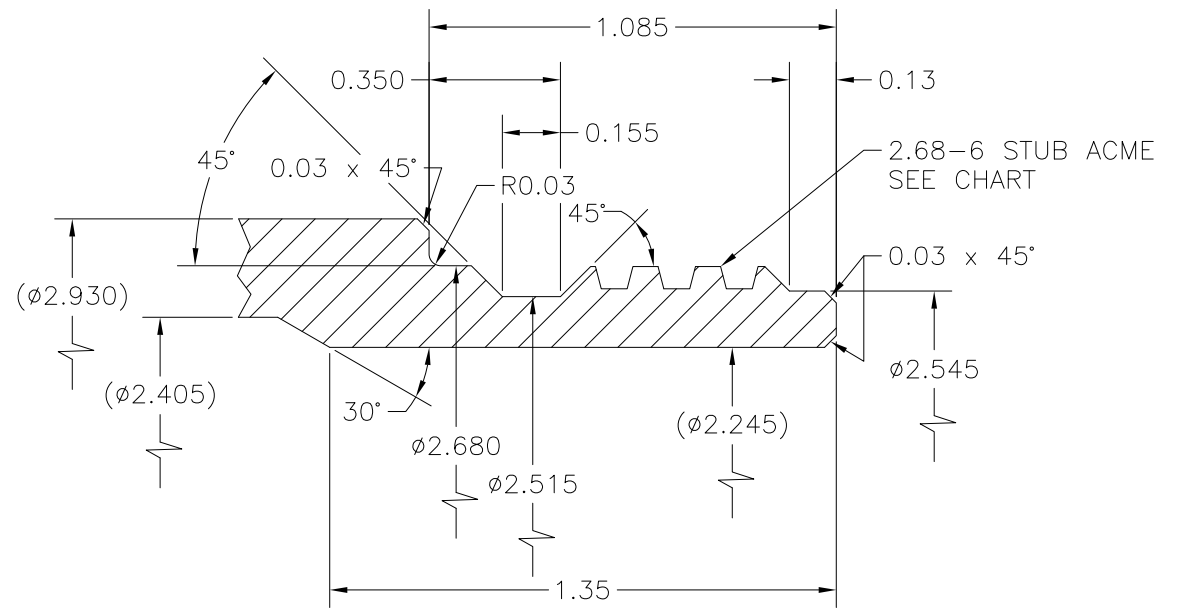

DETAIL 2-C-2
REF. 1-C-4

2.68-6 STUB ACME THREAD EXTERNAL	
MAJOR DIAMETER, MAX.	- 2.680
MAJOR DIAMETER, MIN.	- 2.672
PITCH DIAMETER, MAX.	- 2.617
PITCH DIAMETER, MIN.	- 2.607
MINOR DIAMETER, MAX.	- 2.560
MINOR DIAMETER, MIN.	- 2.550
BASIC THREAD HEIGHT	- 0.050
BASIC WIDTH OF CREST	- 0.067
THREAD PITCH	- 0.167
WIRE SIZE	- 0.081
OVER WIRE DIAMETER MAX.	- 2.699
OVER WIRE DIAMETER MIN.	- 2.689

2.50-8 STUB ACME THREAD INTERNAL	
MAJOR DIAMETER, MIN.	- 2.520
MAJOR DIAMETER, MAX.	- 2.530
PITCH DIAMETER, MIN.	- 2.463
PITCH DIAMETER, MAX.	- 2.473
MINOR DIAMETER, MIN.	- 2.425
MINOR DIAMETER, MAX.	- 2.431
BASIC THREAD HEIGHT	- 0.038
BASIC WIDTH OF CREST	- 0.053
THREAD PITCH	- 0.125

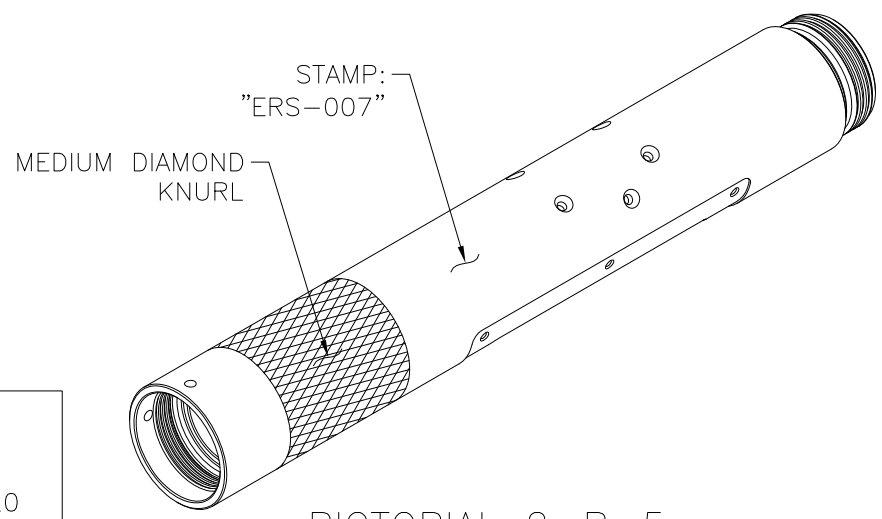

PICTORIAL 2-B-5
MOTOR HOUSING SUB
(LOOKING @ TOP)
N.T.S.

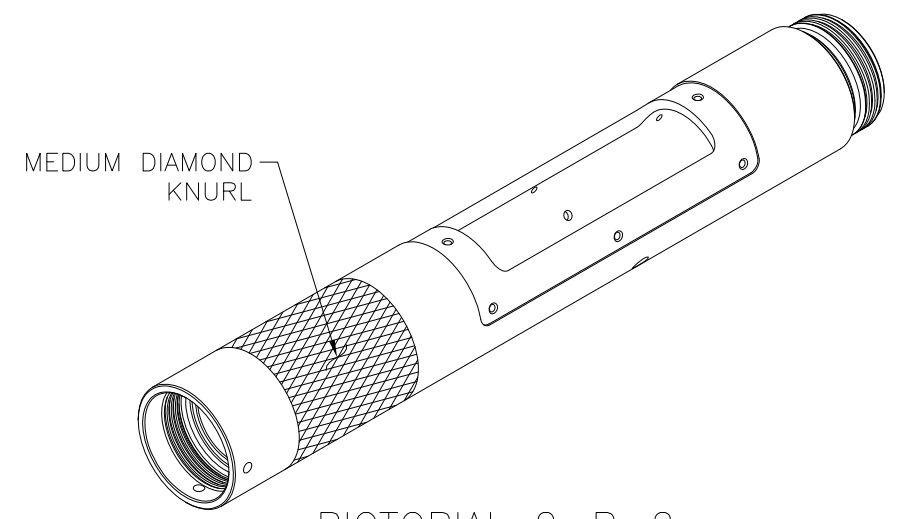

PICTORIAL 2-B-2
MOTOR HOUSING SUB
(LOOKING @ BOTTOM)
N.T.S.

TOLERANCES: UNLESS OTHERWISE SPECIFIED 0.X ± 0.030 0.XX ± 0.010 0.XXX ± 0.005 ANGLES ± 1/2° BREAK EDGES 0.015 x 45° MIN. FINISH 125 [Symbol] 0.010 A ALL DIMS ARE IN INCHES, UNLESS NOTED OTHERWISE.	PROPRIETARY NOTICE THIS DRAWING AND THE INFORMATION IT CONTAINS ARE CONSIDERED CONFIDENTIAL, AND MAY NOT BE REPRODUCED, COPIED OR USED, IN PART OR IN WHOLE, WITHOUT PRIOR WRITTEN CONSENT.	Integrated Ocean Drilling Program TEXAS A&M UNIVERSITY 1000 DISCOVERY DRIVE COLLEGE STATION, TX 77845	
		SHEET 2 OF 2 SCALE 4:1 BY KM DATE 03/30/10	TITLE MOTOR HOUSING SUB SYSTEM ERS v.2 APPROVED TP CHECKED JCS ASSEMBLY 3" ERS SIZE D P/N ERS-007 REV. 1